

**Vectra XL**  
**Liquid Ring Vacuum Pumps and Compressors**



# NASH Vectra XL Vacuum Pumps & Compressors

## Industry Workhorses

NASH liquid ring vacuum pumps produced by Gardner Denver Nash have been known for more than 100 years as tireless workhorses, designed to stand up to the rigorous, nonstop demands of the harshest industrial environments. Built better than industry standards, NASH pumps are known for their reliability.

Vectra XL vacuum pumps and compressors, created specifically for the chemical process industry, combine the highest standard of this reliability with a new level of ingenuity. Gardner Denver Nash employs advanced design technologies to achieve optimum performance and unprecedented production efficiencies. As a result, Vectra XL pumps are economical and provide great value to our customers.

Designed from the ground up based on customer defined market requirements, and the input from R&D, manufacturing, marketing, and most importantly, process engineers, Vectra XL pumps are a revolutionary line of pumps tough enough to be branded NASH.

These pumps include technological advancements such as a patented cone design and rotor configuration. These machines have been specifically designed to excel in applications that require discharging against a positive back pressure. Vectra XL pumps meet high combustible range standards and are ATEX certified. These vacuum pumps and compressors are in accordance with guideline 94/9/EG, category 1 and 2 and were also designed with API 681 specifications in mind.

Features	Benefits
Compact design	Less floor space required
External mechanical seals	Flexibility & ease of maintenance
Universal stuffing box	Accepts variety of mech. seals
Global product design	Direct drive speeds for 60 Hz & 50 Hz motors
Extended pressure ratings	Ability to handle tough applications where back pressure is required
Conical design	Better ability to handle water/particulate slugs
One moving part	Long term reliability
Variable port design	High efficiency
Lobe purges	Reduce erosion wear
NASH patented Gas Scavenging	Increased performance at high vacuum levels
Redesigned cone angle	Reduced pump length
Optimum design using finite element analysis	Improved efficiency, performance and value
100% performance tested	Trouble-free start-up and operation

## Vacuum technology for chemical processing

Vectra XL pumps are designed to stand up to the harsh environments found in the chemical process Industry. They are available in both ductile iron and stainless steel and can accommodate a variety of mechanical seals. Key elements of the design are the improved cone angles, which decrease the size of the pump, and NASH patented Gas Scavenging Technology, which dramatically improves pump performance at high vacuum levels.

### Basic specifications

Vacuum range	to 33 mbar abs. / 0-29 in Hg vac
Mechanical seals*	Single, double and cartridge
Differential pressure capability	2 bar / 30 psi
Compressor pressure	3 bar abs. / 30 psig
Hydrotest pressure	11 bar abs. / 150 psig standard (16 bar abs. / 225 psig optional)
Construction material	Ductile iron, stainless steel

\* Mechanical seals are standard on stainless steel Vectra XL 35 - 150 models. Optional on others.

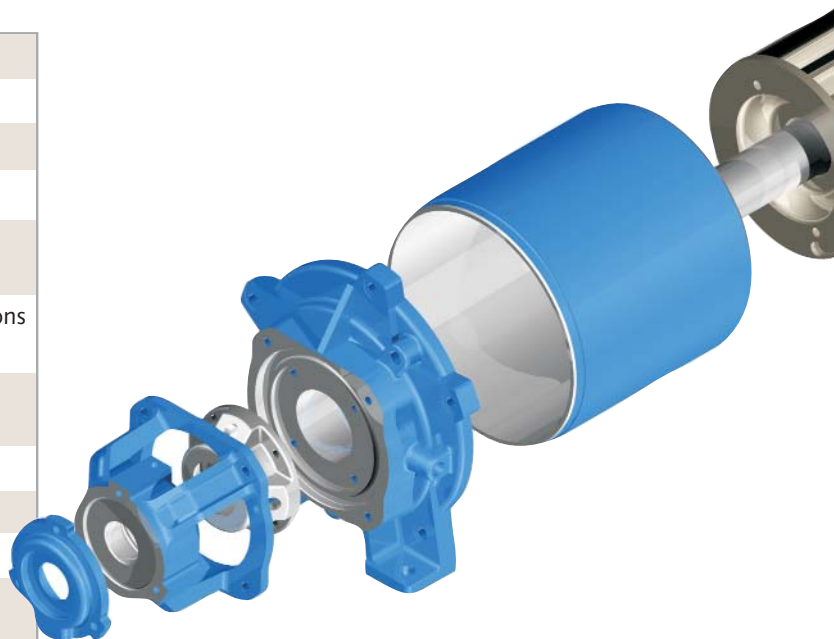

## Performance

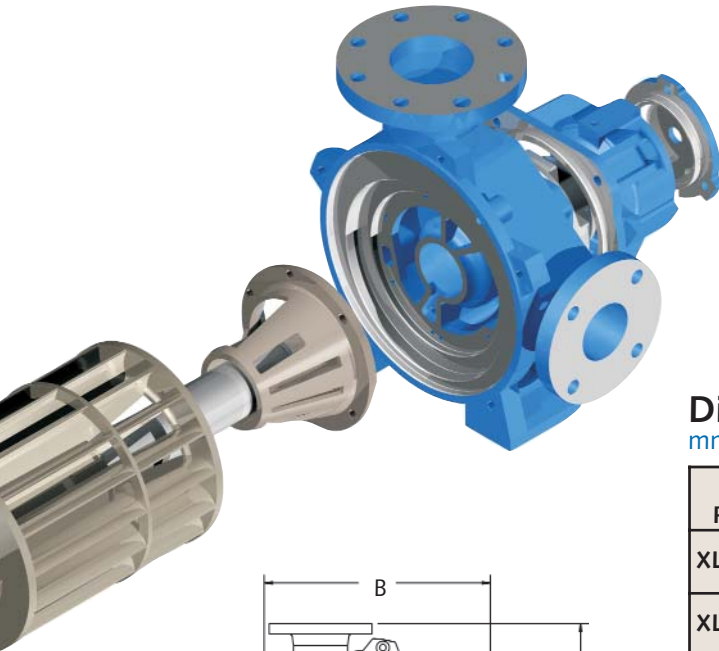
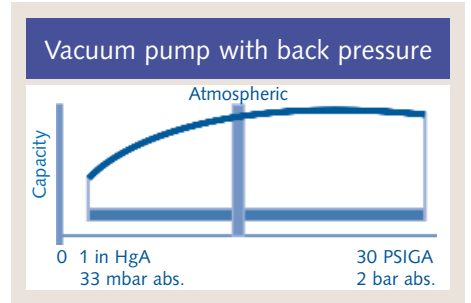
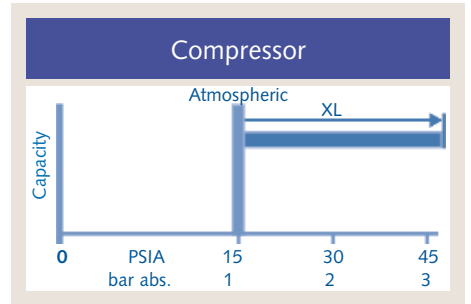
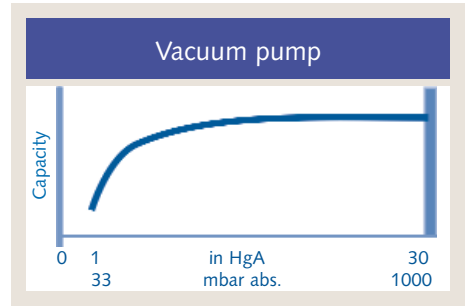
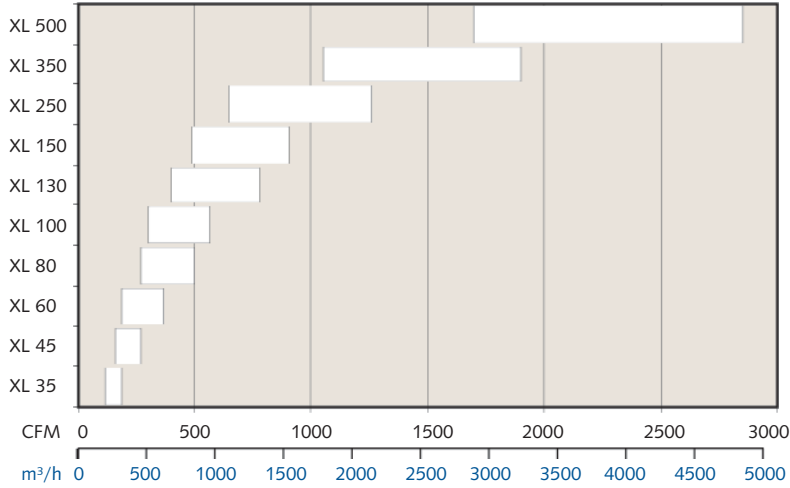

## Dimensions

mm in blue

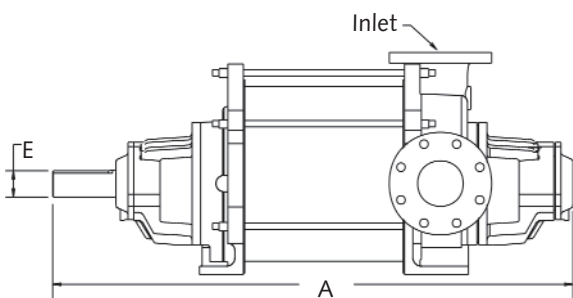
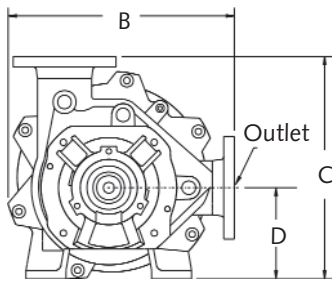

Pump	A	B	C	D	E	Inlet	Outlet
XL 35	30 762	13.4 340	14 356	6 152	1.6 42	3 in. FLG 80 mm FLG	2 in. FLG 50 mm FLG
XL 45	32.4 823	13.4 340	14 356	6 152	1.6 42	3 in. FLG 80 mm FLG	2 in. FLG 50 mm FLG
XL 60	36 914	17 432	16 406	6.8 173	1.9 48	4 in. FLG 100 mm FLG	3 in. FLG 80 mm FLG
XL 80	39 991	17 432	16 406	6.8 173	1.9 48	4 in. FLG 100 mm FLG	3 in. FLG 80 mm FLG
XL 100	42 1067	19 483	19.5 495	8 203	2.4 60	4 in. FLG 100 mm FLG	4 in. FLG 100 mm FLG
XL 130	46 1168	19 483	19.5 495	8 203	2.4 60	4 in. FLG 100 mm FLG	4 in. FLG 100 mm FLG
XL 150	48 1219	21 533	21.5 546	8.5 216	2.4 60	6 in. FLG 150 mm FLG	4 in. FLG 100 mm FLG
XL 250	55 1397	26 660	26.5 673	11.5 292	3.0 76	6 in. FLG 150 mm FLG	6 in. FLG 150 mm FLG
XL 350	64 1626	29 737	31 787	13 330	3.4 85	8 in. FLG 200 mm FLG	6 in. FLG 150 mm FLG
XL 500	72.4 1840	39 965	37 940	15.5 394	3.75 95	10 in. FLG 250 mm FLG	8 in. FLG 200 mm FLG

All dimensions are approximate

## Other NASH Products

**2BV** Compact liquid ring vacuum pumps built for serious cost savings  
Use up to 50 percent less water than other liquid ring pumps  
Monoblock and pedestal designs available  
Capacity of 7 to 595 m<sup>3</sup>/h with vacuum to 33 mbar abs  
Capacity of 4 to 350 CFM with vacuum to 29+'' HgV



### GARO Compressors

Highly rugged and reliable compressors that can handle highly toxic, explosive and corrosive gases  
Specifically developed for applications such as flare-gas, chlorine and Vinyl Chlorine Monomer (VCM) recovery  
Capacity of 100 to 3,400 m<sup>3</sup>/h with pressure to 15 bar abs  
Capacity of 2,200 SCFM with pressure to 200 PSIG  
Single and two stage models available



### 2BE3/P2620

Large liquid ring vacuum pumps with superior corrosion resistance  
Top discharge capability which eliminates need for trench  
Self-recirculating seal water, reducing need for external seal water source  
Capacity of 6,800 to 39,000 m<sup>3</sup>/h with vacuum to 31 mbar abs  
Capacity of 4,000 to 23,000 CFM with vacuum to 29+'' HgV



### TC/TCM

Integral 2 stage liquid ring pumps with improved performance at vacuum levels down to 27 mbar abs / 0.8'' HgA  
Designed to handle large amounts of liquid carryover without difficulty  
Capacity of 170 to 3,740 m<sup>3</sup>/h with vacuum to 27 mbar abs  
Capacity of 100 to 2,200 CFM with vacuum to 0.8'' HgA



### Steam Jet Ejector

Sizes range from 25 mm (one-inch) to 2 meters (78-inch) inlets  
Capacities range from 34 m<sup>3</sup>/h to 34,000 m<sup>3</sup>/h  
Capacities range from 20 CFM to 20,000 CFM  
Multi-stage system pressures as low as 0.001 HgA



**Gardner Denver Nash  
Deutschland GmbH**  
Katzwanger Straße 150  
90461 Nürnberg, Germany  
phone: +49 911 1454-0  
fax: +49 911 1454-6935  
info@de.gardnerdenver.com  
GardnerDenverNash.com

**Gardner Denver  
Liquid Ring Pump Division**  
9 Trefoil Drive  
Trumbull, CT 06611, USA  
phone: +1 800 553 NASH  
fax: +1 203 459 3988  
nash@gardnerdenver.com  
GardnerDenverNash.com